



# The Convention Daily

Michigan District of The Lutheran Church—Missouri Synod  
104th Michigan District Convention

Sunday, June 22, 2025

## Welcome to the 104th Michigan District Convention!

Dear Brothers and Sisters in Christ,

On behalf of the Convention Planning Team, WELCOME to the 104th Convention of the Michigan District of the Lutheran Church—Missouri Synod. We are so glad you have made it a priority in your busy schedules to join us here on the beautiful campus of Concordia University Ann Arbor for this convention. It is our hope and prayer that over these next three days, being “People of Hope,” we can collectively:

- Celebrate the work God is doing among us in the district, and the blessing Concordia University Ann Arbor has been to the Michigan District;
- Encourage one another in our continued work together;
- Conduct the official business of the Michigan District in a way that brings glory to God.

The theme for the Convention is “*Nourished for the Journey ... Remember; Renew, Return.*” It’s based on the account of Elijah in 1 Kings 19. We hope you all have had a chance to participate in the Bible study that Rev. Dr. Walter A. Maier III prepared for the convention. It offers great insight into Elijah in his time, and how it encourages us today. As Dr. Maier states, “God’s relationship with Elijah gives us guidance for our work in the Church. We need to stand for the Lord and His Word, stand on His Word, and be in His Word and Sacrament.” May our time together in worship services, in the Convention Hall, in the Ministry Tent, and at meals or during breaks help us REMEMBER how God has richly blessed the Michigan District, RENEW us for greater service to HIM, so that we can RETURN to our congregations and ministries, Nourished for the Journey by STANDING on the Lord—HIS WORD and SACRAMENT.

Please give a hearty “Thank You” to several congregations, their teams, and organizations who have hosted and sponsored our meals. This is something new to the convention this year. We are hoping your meal experiences will bring a positive vibe to our time together.

It’s been a privilege and honor to serve with the members of the Convention Planning Team in preparation for this convention. We are here to serve you, so please seek us out if we can help you in any way. Thanks be to God for this opportunity to gather and be nourished in Word and Sacrament, and to Remember, Renew, and Return for service to HIM!

In HIS service,

*O. Dennis Sohn*

O. Dennis Sohn, Chairman

2025 Convention Planning Team

### Inside this Issue ...

Convention Orientation .....	2	Prayer and Morning Walks .....	5
Reporting and Implementing .....	2	Convention Offering and Ingathering .....	5
A Primer of Parliamentary Law and Procedure ...	2	Today’s Thank Yous .....	5
Convention Glossary .....	2	Campus Map .....	6
Advisory Delegate Polling .....	4	Scavenger Hunt .....	7
In Case of Emergency .....	4	Possible Monday Session .....	7
Livestream and Participant Release .....	4	Wireless Internet Usage .....	7
Book Signing .....	5	Connect with the Michigan District, LCMS ...	7
Convention Meals .....	5	Ministry Tent Layout/Exhibitors .....	8

## Convention Orientation

### Reporting and Implementing

As a delegate, you serve a three-year term, beginning with the Pre-Convention Regional Assemblies. You are expected to help implement the resolutions of the convention and you are also expected to report to the people who sent you. Voting delegates will be called upon to report to their individual congregation. Therefore, it is recommended that you save copies of all resolutions and mark them whether they have been adopted, amended, or defeated. The Convention Proceedings, containing all actions of the convention, will reach you in about three months. During your three-year term you will also function as a resource person and assist in the dissemination and implementation of the District resolutions.

Thank you for your service. May God bless the Convention and may His name be praised!

## A Primer of Parliamentary Law and Procedure

### Purpose of Parliamentary Law and Procedure

The purpose of parliamentary procedure is to carry out the aims of the assembly in an orderly and fair manner, to expedite business, to insure justice and fairness to all, both the majority and the minority.

It is not the purpose of parliamentary procedure to make the conduct of business in an assembly difficult, or to entangle an assembly in technicalities, or to provide a channel for individuals to flaunt their parliamentary knowledge.

Parliamentary law “embodies the basic principles of equal rights, the rule of the majority, the protection of the minority, and the orderly consideration of one subject at a time” (Clarence Cannon, Amer. Enc., Vol. 21, p. 338).

### Basic Steps of Parliamentary Procedure

The chairman of the assembly should be acquainted with and observe eight basic, essential parliamentary steps to take care of convention business in an orderly and fair manner. They are:

#### Members:

1. Address the Chair. “Mr. Chairman” or “Mr. President”

### Convention Orientation Schedule

All delegates are encouraged to attend one of two identical **Delegate Orientations** held on Sunday, June 22 from 5–5:30 p.m. and Monday, June 23 from 7:30–8 a.m. in the Convention Hall (Gym).

2. Await recognition by the Chair.
3. Make a motion. “I move that...”
4. Second the motion. (Unless not required)

#### Chair:

5. States the motion. (Or rules it out of order)
6. Calls for discussion. (Unless motion is undebatable)
 

“Is there any discussion?” or “Are there any remarks?” Ample opportunity must always be given for expression of opinion and for discussion.
7. Takes the vote. (Or “Puts the questions”)

First calls for the affirmative vote, then the negative. A tie vote defeats the motion, since a majority is required to adopt unless the motion requires a 2/3 vote.

8. States the results.

“The ‘ayes’ have it and the motion is carried.” Or, “the ‘no’s’ have it and the motion is lost.” The vote does not go into effect until the results are announced.

## Convention Glossary

Ad Hoc Committee	Special committee with a limited assignment and a limited life.
Agenda	List of items of convention business “to be done.”
Amend	To change or modify a resolution or motion.
Appeal	An appeal from a decision of the chair requires that the decision be referred to the convention for its immediate decision by a vote.

Division of the House	A vote taken by rising to verify a voice vote at the call of the chair or at the request of a voting delegate.	Out of Order	Not correct from a parliamentary standpoint at that particular time.
Floor Committee	A working group of convention voting and advisory delegates to whom the processing of a share of convention business is entrusted for recommendation in turn to the convention proper.	Parliamentarian	A person or persons designated by the chair to advise him on the applicability of parliamentary principles and procedures in a given situation.
General Consent	An informal method of disposing of routine and generally favored proposals by assuming approval of a request unless immediate objection is raised.	Pending	Not yet decided. A pending motion is one that has been stated by the chair but is not yet disposed of by vote.
Handbook	A manual containing the Synodical Articles of Incorporation, the Synodical Constitution and the Bylaws. District Bylaws are contained in the Proceedings from the previous convention.	Point of Order	Any delegate may promptly call attention to the fact that the rules of the Synod or its convention are seemingly not in force by saying "I arise to a point of order." Upon hearing the point made, the chair rules as to its validity.
Lay on the Table	To set aside a motion or a proposed resolution for consideration in the indefinite future. If adopted, it usually kills consideration of an action on the main motion by postponing it without a set time to take it up again. If this is not the intent, the motion should really be not to table but to postpone, preferably to a set time.	Postpone	To defer action on a question or proposed resolution (1) indefinitely or (2) until a certain specified time.
Majority	More than half the votes cast. The Synodical Constitution provides: "All matters of doctrine and of conscience shall be decided only by the Word of God. All other matters shall be decided by a majority vote." This means a simple majority in all instances except those which involve a proposed constitutional amendment; these require a two-thirds affirmative vote of all votes cast. All elections are determined not by simple plurality but by absolute majority.	Previous Question	A motion calling for the previous question is a complete and separate motion, non-debatable, and stops all discussion or debate if two-thirds of the voting delegates vote "aye" after a motion has been made and seconded to call for the previous questions. When two-thirds of the voting delegates have responded "aye," the Chair must immediately call a vote on the motion pending before the convention.
		Privileged Motion	A motion, such as to recess, to fix the time of the next session and to change the order of the day. It takes precedence over all other motions.
		Putting the Question	The taking of the vote by the chair.
		Question	A subject or point of debate or a resolution being or to be voted on.

Quorum	The fewest number of delegates that can be present and still permit business to be transacted. For LCMS District conventions, <i>“... the presence of at least one-third of the voting members represented by at least one of their respective representatives (pastor or lay delegate) are required (Constitution, Article V B).”</i>
Report	Usually the formal accounting given by an officer, board, commission, or committee in the discharge of its responsibilities. Such accounting is to be evaluated by the District Convention.
Rescind	To annul or to cancel. To undo or reverse a previous decision.
Substitute Amendment	When a full paragraph, section, or resolution is dropped and another is inserted in its place.

### Meal tickets are INSIDE your name badge!

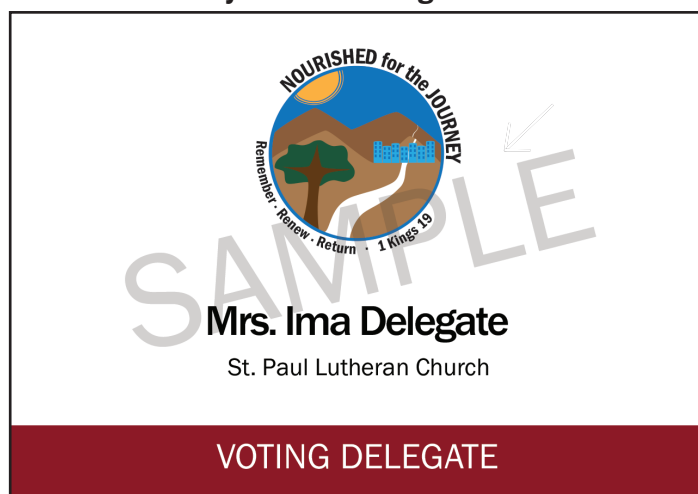

### Wondering Where to Sit?

Your name badge band color will guide you!

- Red band = Voting Delegates — please sit at the red tables.
- Gold band = Advisory Delegates — please sit at the gold tables; if full, please sit in the bleachers.

All others are invited to find a seat in the bleachers. No matter where you sit, we're glad you're here!

### Advisory Delegate Polling

Advisory delegates (commissioned ministers of the District, ordained ministers of the District not serving as voting delegates for their congregations, and advisory lay delegates from multi-congregation parishes) are able to participate in an advisory poll on the main motion to any numbered resolution from a floor committee.

Polling will be done through an online system at [slido.com](https://slido.com). To participate, each advisory delegate will need to use his/her own device with an internet browser and will log in with the email they provided during registration. They will also need to receive a validation code through email. If you do not have a device, please go to the Press Room. **Please be sure to attend one of the Delegate Orientations to learn how to use the online polling system.**

### In Case of Emergency

For injury or illness requiring emergency health responders, call 911. If another type of emergency should arise, please call Campus Security at 734.358.1340.

### Livestream/Participant Release

[michigandistrict.org/live](https://michigandistrict.org/live)

The convention proceedings and worship services will be streamed via an online service. Portions of the convention will be made available online for post-convention on-demand viewing.

Participants who choose to engage in the proceedings of the convention give the Michigan District, LCMS implicit permission to record, broadcast, transcribe, and publish the audio and video. No signed release by the participant is required. Other recording, transcriptions, publication, and copyright information can be found in Section 2, page 176 of the Convention Workbook - Part II.

*CEF is the preferred source of loan funding for building and renovation projects in the Michigan District. We also provide ministries and LCMS members with a powerful way to invest their funds—earning a great rate of return while helping build God's Kingdom through churches, schools, and other ministries across the District.*



Church Extension Fund

800-242-3944 • [www.mi-cef.org](http://www.mi-cef.org) • [cef@mi-cef.org](mailto:cef@mi-cef.org)



## New at Convention This Year in the Ministry Tent

Visit the Author's Book Signing table in the Ministry Tent featuring several authors from our very own Michigan District. Their books will be available for purchase—and you'll have the chance to get your copy personally signed. Don't miss this special opportunity. View the full signing schedule by scanning the QR code.



## Convention Meals

Please note: Monday and Tuesday breakfasts will be served in the Cafeteria. Lunches and Monday's dinner will take place in the Manor Tent.

## Join the 7,000

It is our privilege to bring the elections and business before the Lord in prayer during the hours of convention. For this purpose, we have enlisted off-site prayer partners through *Join the 7,000*. Prayer prompts are available in the press room as well as online at [michigandistrict.org/convention](http://michigandistrict.org/convention). If you would like to join in prayer on site or need a quiet place, a prayer room has been set up. Follow the signs in the gym. Prayer requests can be placed in the red box located just outside of the prayer room. Urgent matters should be brought to the Press Room.

## Morning Walks

A prayer walk will take place on Monday and Tuesday mornings at 7 a.m. Des. Christie Hansard, RN has put together a Prayer Walk Guide using the Wholeness Wheel as a tool. Pick up your guide at the Parish Nurse booth in the Ministry Tent and join others in prayer each morning.

## Convention Offering and Ingathering

The convention offering during the Opening Worship will support the work of the the Love Ypsilanti Diaper Pantry, a joint ministry between Cross and Resurrection and Faith Lutheran Churches in Ypsilanti. You can find a list of needs at [michigandistrict.org/convention/convention-ingathering/](http://michigandistrict.org/convention/convention-ingathering/) or, to make a financial donation, use the QR Code. A van will be positioned near the parking lot at the back of the gym for donation drop-off. Look for the feather banners!



## Today's Thank Yous

- **Concordia University Ann Arbor staff** for hosting the convention;
- **Rev. Dr. Jeffrey T. Schrank** (Christ Church Lutheran, Phoenix, AZ) for sharing his inspiration, energy, and wealth of experience in the area of meals and hospitality;
- All our **incredible volunteers**, who helped create a festive and welcoming atmosphere through meals, snacks, and hospitality;
- **St. John, Rochester**, for providing today's picnic dinner and entertainment at the Ministry Tent.
- The congregation of **St. Luke, Ann Arbor** who is hosting the Opening Worship.
- **Church Extension Fund** for providing donuts and water bottles.



## Sunday Highlights

**Registration**  
Cardinal's Nest  
1–7 p.m.  
8:15–9 p.m.

**Ministry Tent**  
West Campus Parking Lot  
3–6:30 p.m.

**Dinner and Music**  
by St. John, Rochester  
Ministry Tent  
4–6 p.m.

**Delegate Orientation**  
Convention Hall/Gym  
5–5:30 p.m.

**Choir Practice**  
Chapel  
5 p.m.

**Opening Worship**  
Chapel  
7 p.m.

**Sundaes on Sunday**  
Chapel Lawn  
8:15 p.m.

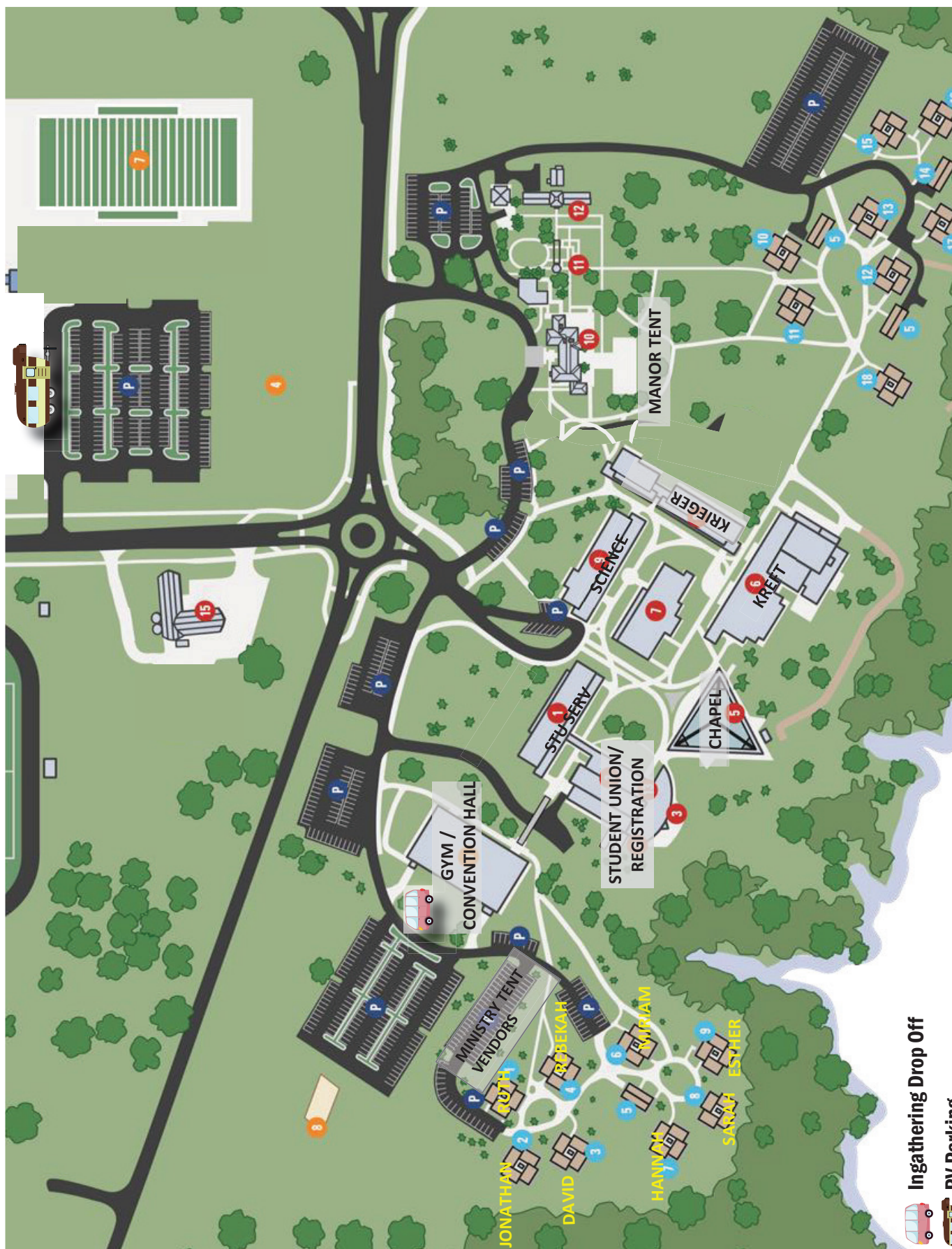



## Scavenger Hunt

This year's convention will provide the opportunity to be part of a Scavenger Hunt celebrating the partnership between the Michigan District and Concordia University Ann Arbor through the years.

At registration, everyone will receive a bag containing a bandana, a marker, and clues to assist in wandering across campus to solve puzzles, play games, meet people, and possibly learn new facts about the campus.

You can work alone, with a partner, or in groups to fill the squares of your bandana. When finished, the bandana will be your remembrance of the countless blessings God has bestowed on Concordia University Ann Arbor and the Michigan District.

## Possible Evening Sessions

Please note in the convention agenda that a **possible 8 p.m. Monday evening session may occur**. If the evening session is necessary, an announcement will be made prior to the end of the Monday afternoon session.

## Wireless Internet Usage

To access WiFi in the dorms, convention participants are welcome to utilize Concordia's network. *User name:* reshall *Password:* C0rkyPlayz. Please refer to Section 2, page 175 of the Convention Workbook – Part II for Standing Rules regarding proper Internet usage during convention proceedings. Please note that **all voting delegates** are asked to turn off their WiFi service during convention sessions. Please use cellular service only. Advisory Delegates will be permitted to use WiFi service for their polling needs only.



## Connect with the Michigan District, LCMS >>> [michigandistrict.org](http://michigandistrict.org)



Michigan District, LCMS  
[facebook.com/milcms](https://facebook.com/milcms)



[x.com/milcms](https://x.com/milcms)



[instagram.com/milcms](https://instagram.com/milcms)



Storybucket - Submit stories here!  
[michigandistrict.org/storybucket](https://michigandistrict.org/storybucket)



PODCAST NETWORK  
[michigandistrict.org/podcast](https://michigandistrict.org/podcast)



READ District staff and guest blogs at [michiganintouch.com](https://michiganintouch.com)



STAY INFORMED with weekly e-news. Subscribe at [michigandistrict.org/enews](https://michigandistrict.org/enews)



CONVENTION VIDEOS will be archived at [youtube.com/michiganLCMS](https://youtube.com/michiganLCMS)

Michigan District of The Lutheran Church – Missouri Synod | 3773 Geddes Road, Ann Arbor, Michigan 48105-3098

Phone: 734.665.3791 | Toll Free: 888.225.2111 | Fax: 734.665.0255 | [michigandistrict.org](http://michigandistrict.org) | [facebook.com/milcms](https://facebook.com/milcms) | [twitter.com/milcms](https://twitter.com/milcms)

*People of Hope...Vigorously Making Known the Love of Christ*

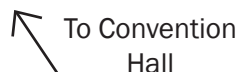

Meet the  
Author

# Ministry Tent Booth Layout

1 Michigan District, LCMS Information & NYG T-Shirt Pickup	
2 Parish Nursing CCWC	
3 Michigan District Constitution Review	
4 Michigan District Archives	
5 A City on a Hill	
6 Lutheran Benefits Group & Lutheran Trust	
7 Christian Outreach for Africa	
8 Concordia Publishing House	
9 Chime Master	
10 Concordia Center for the Family	
11 Camp Concordia	
12 Alliance Defending Freedom	
13 The Center	

27 Michigan District, LCMS Development	
26 Michigan District Lutheran Schools	
25 Michigan School of Missional Formation	
24 Campus Ministry	
23 Franklin Ave Mission Inc.	
22 Fellowship Development	
21 Harvest Partnership Michigan	
20 Martin Luther's Evening Prayer	
19 Concordia University Chicago	
18 West Michigan Lutheran School	
17 Prison Fellowship	
16 Crafts from Jerusalem	
15 Mighty Fortress Foundation	
14 Church Extension Fund	
28 LSEM	
29 Lutherans for Life of Michigan	
30 Love Ypsilanti Mission	
31 Gifts For All God's Children	
32 Ephphatha Lutheran Mission Society	
33 Concordia Historical Institute	
34 Lutheran Heritage Foundation	
35 Concordia Plans	
36 Concordia University Wisconsin & Ann Arbor	
37 MOST Ministries	
38 Concordia Seminaries CSL/CTSFW	
39 Purposeful Journeys	

52 Connection by Design	
51 Orphan Grain Train MI	
50 Educational Opportunity Tours	
49 Best Practices Heartland	
48 Tree of Life Imports	
47 Trinity HOPE	
46 POBLO International	
45 Holy Land Christian Solidarity Cooperative	
44 Lutheran Bible Translators	
43 Lutheran Braille Workers	
42 Lutheran Hour Ministries	
41 LCMS Foundation	
40 UTEC	

## Food and Drink Area