

St.  
Peter  
MACOMB

**St. Peter Lutheran Church and School**  
**17051 24 Mile Rd., Macomb, MI 48042**  
**[www.splcs.com](http://www.splcs.com) (586) 781-9296**



## TUITION 2013-2014

St. Peter Lutheran School

visit [www.sples.com](http://www.sples.com) for more info

*Caring for Today . . . Preparing for Tomorrow*

A non-refundable \$120 fee per family is due with application/re-enrollment form which is deducted from annual tuition total.

There is a 3% discount if tuition is paid in FULL by June 15th.

Tuition is due by the 1st of every month beginning June 1st through May 1st.

Full payment for the year is due by the 1st of every month beginning June 1st through May 1st.  
r family



**OUR OPEN HOUSE**  
school through 8th grade

**Friday, January 27, 2013**

**11:30 am to 1:30 pm**

(Kindergarten Presentations  
11:45am & 12:30pm)

**17051 24 Mile Rd  
Macomb, MI 48042  
586-781-9296  
[www.sples.com](http://www.sples.com)**

*Leading*

## APPLICATION FOR ENROLLMENT

1ST - 8TH GRADE SCHOOLS

School  
MI 48042  
9296

St. Peter Lutheran Church and School  
*"Sharing the Heart of the Savior in the Heart of Macomb."*



Kyle B. Chuhran  
Principal

School: (586) 781-9296

Church: (586) 781-3434

Fax: (586) 781-9726

Fax: (586) 781-6564

Email: [kchuhran@sples.com](mailto:kchuhran@sples.com)

[www.sples.com](http://www.sples.com)

17051 24 Mile Road • Macomb, Michigan 48042

## ABOUT US

St. Peter Lutheran School

## WHAT LUTHERANS BELIEVE AND TEACH

St. Peter Lutheran School

## WE ARE PROUD TO OFFER . . .

St. Peter Lutheran School

## TESTIMONIALS

St. Peter Lutheran School

## PATRIOT SPORTS

St. Peter Lutheran School

*Caring for Today . . . Preparing for Tomorrow*

visit [www.sples.com](http://www.sples.com) for more info

## WELCOME

St. Peter Lutheran School

## FLOOR PLAN

St. Peter Lutheran School

*Caring for today . . . Preparing for Tomorrow*

visit [www.sples.com](http://www.sples.com) for more info

St. Peter Lutheran Church and School  
*"Sharing the Heart of the Savior in the Heart of Macomb."*



Renee Finkel  
Admissions Counselor

School: (586) 781-9296

Church: (586) 781-3434

Fax: (586) 677-2839

Fax: (586) 781-6564

Email: [rfinkel@sples.net](mailto:rfinkel@sples.net)

[www.sples.com](http://www.sples.com)

17051 24 Mile Road • Macomb, Michigan 48042



# St. Peter

MACOMB

St. Peter Lutheran Church and School  
17051 24 Mile Rd., Macomb, MI 48042  
www.spcls.com (586) 781-9296

St. Peter Lutheran Church and School  
*"Sharing the Heart of the Savior in the Heart of Macomb."*



Kyle B. Chuhran  
*Principal*

School: (586) 781-9296

Fax: (586) 781-9726

Email: [kchuhran@spcls.com](mailto:kchuhran@spcls.com)

Church: (586) 781-3434

Fax: (586) 781-6564

[www.spcls.com](http://www.spcls.com)

17051 24 Mile Road • Macomb, Michigan 48042

St. Peter Lutheran Church and School  
*"Sharing the Heart of the Savior in the Heart of Macomb."*



Renee Finkel  
*Admissions Counselor*

School: (586) 781-9296

Fax: (586) 677-2839

Email: [rfinkel@spcls.net](mailto:rfinkel@spcls.net)

Church: (586) 781-3434

Fax: (586) 781-6564

[www.spcls.com](http://www.spcls.com)

17051 24 Mile Road • Macomb, Michigan 48042



# St. Peter Lutheran School

## OPEN HOUSE for future PATRIOTS

*Preschool through 8th grade*

*Caring for Today . . . Preparing for Tomorrow*



NLSA & MANS  
Accreditations

*We are proud to offer:*

- *Faith-Based Education*
- *Dedicated & Qualified Staff*
- *Small Class Sizes*
- *Christ-Centered Environment*
- *First-Rate Academic Curriculum*
- *Excellent Athletic Program*
- *Recent Technology Enhancements*
- *Safe & Secure Atmosphere*
- *Band/Choir/Handbells*
- *Prominent Facility & Location*
- *Extra-Curricular Activities*
- *Utica School Busing System*

*Learning*



*Loving*

JOIN US FOR OUR **OPEN HOUSE**

*Preschool through 8th grade*

**Sunday, January 27, 2013**

**11:30 am to 1:30 pm**

(Kindergarten Presentations  
11:45am & 12:30pm)

**17051 24 Mile Rd  
Macomb, MI 48042  
586-781-9296  
www.splcs.com**

*Leading*

**St. Peter Lutheran School** (since 1877)  
**OPEN HOUSE** for future PATRIOTS  
*Preschool through 8th grade*



17051 24 Mile Rd.  
Macomb, MI 48042  
586-781-9296  
[www.splcs.com](http://www.splcs.com)

Please  
place  
stamp  
here

*"I thank God for being true to His Word, and I thank the staff and families of St. Peter Lutheran School for making my son and I feel so welcome and included in ALL school activities during his first year at St. Peter in the 4th grade, and for the continued friendships that have developed and continued into our second year at the school. I am happy to say that St. Peter Lutheran School welcomed my family warmly, and immediately felt like "home", and still does today." Parent Testimonial*



*Meet our Staff*

*Tour our Facility*

*Families Welcome*



# APPLICATION FOR ENROLLMENT

1ST - 8TH GRADE SCHOOL APPLICATION

St. Peter Lutheran School  
17051 24 Mile Rd  
Macomb, MI 48042  
(586) 781-9296  
www.splcs.com

## STUDENT INFORMATION

Child's Last Name \_\_\_\_\_ First \_\_\_\_\_ Middle \_\_\_\_\_  Male  Female

Grade Entering: (circle one) Kindergarten  Full  Half 1 2 3 4 5 6 7 8

Birth Day (mo/day/yr) \_\_\_\_\_ Place of Birth (city) \_\_\_\_\_ Baptism Date (mo/day/yr) \_\_\_\_\_

Ethnic Origin  American Indian  African-American  Asian  Caucasian  Hispanic  Other/Multiracial

Allergies/Heath Concerns \_\_\_\_\_

Has the child ever been tested for Special Education Services:  yes  no If YES please check appropriate box (es) below:

Speech & Language  Learning Disabilities  Autism  Other \_\_\_\_\_

Public School District \_\_\_\_\_ Last School Attended \_\_\_\_\_ Teacher's Name \_\_\_\_\_

Former School Address \_\_\_\_\_ City \_\_\_\_\_ State \_\_\_\_\_ Zip \_\_\_\_\_

Former School's Phone # \_\_\_\_\_ Fax # \_\_\_\_\_

Student Lives With:  Both Parents  Mother  Father  Other \_\_\_\_\_

Please use reverse side of application for any additional information you would like to provide.

Parents Are:  Married  Divorced  Widowed  Other \_\_\_\_\_

Siblings in Students Home: Name \_\_\_\_\_ Age \_\_\_\_\_ Name \_\_\_\_\_ Age \_\_\_\_\_

## FATHER'S INFORMATION

Father's Name \_\_\_\_\_

Street Address \_\_\_\_\_

City \_\_\_\_\_ State \_\_\_\_\_ Zip \_\_\_\_\_

Home Phone # \_\_\_\_\_ Cell # \_\_\_\_\_

Email address (primary) \_\_\_\_\_ @ \_\_\_\_\_

Employer/Occupation \_\_\_\_\_

Work Phone # \_\_\_\_\_

Church Membership \_\_\_\_\_

Denomination \_\_\_\_\_

## MOTHER'S INFORMATION

Mother's Name \_\_\_\_\_

Street Address \_\_\_\_\_

City \_\_\_\_\_ State \_\_\_\_\_ Zip \_\_\_\_\_

Home Phone # \_\_\_\_\_ Cell # \_\_\_\_\_

Email address (primary) \_\_\_\_\_ @ \_\_\_\_\_

Employer/Occupation \_\_\_\_\_

Work Phone # \_\_\_\_\_

Church Membership \_\_\_\_\_

Denomination \_\_\_\_\_

## STEP-FATHER, STEP-MOTHER OR GUARDIAN INFORMATION Name \_\_\_\_\_

Check if address/phone number is same as:  Father  Mother  Neither (please use reverse side of application if different address)

How did you find out about St. Peter Lutheran School \_\_\_\_\_

I, the undersigned, agree to:

Support all school rules and regulations  Worship regularly with my child at a Christian Church  Make monthly tuition payments

Signature of Parent or Guardian \_\_\_\_\_ Date \_\_\_\_\_

-----  
for office use only

Date Application Rec'd \_\_\_\_\_  Application Fee Received (\$120 non-refundable) Check # \_\_\_\_\_

# TUITION 2013-2014

St. Peter Lutheran School

*Caring for Today . . . Preparing for Tomorrow*

visit [www.sples.com](http://www.sples.com) for more info

A non-refundable \$120 fee per family is due with application/re-enrollment form which is deducted from annual tuition total.

There is a 3% discount if tuition is paid in FULL by June 15th.

Tuition payments are due the 1st of every month beginning June 1st through May 1st.

Full Day kindergarten monthly payment reflects both the application fee of \$120 per family and a \$500 deposit which is due on May 1st.

## TUITION RATES 2013/14

	Annual	Monthly*
<b>MEMBER of St. Peter Lutheran Church</b>		
1st Child	\$2,796	\$223
2nd Child	\$2,208 (additional)	\$407
3rd Child	\$1,392 (additional)	\$523
Kindergarten (Half)	\$2,604	\$207
Kindergarten (Full)	\$4,100	\$290
<b>COMMUNITY</b>		
1st Child	\$5,292	\$431
2nd Child	\$3,900 (additional)	\$756
3rd Child	\$3,348 (additional)	\$1,035
Kindergarten (Half)	\$3,096	\$248
Kindergarten (Full)	\$4,592	\$331

- Monthly rate reflects payment after \$120 application/re-enrollment fee is deducted.
- Full Day Kindergarten payments after \$120 application fee and \$500.00 deposit.



# DRESS CODE

Dress standards for St. Peter Lutheran School should reflect excellent taste. All clothing should be modest, neat, clean and be such that it reflects a Christian image to the community and will not impair the normal school process. The school administration reserves the right to counsel all members of the school community regarding dress and grooming and to discipline those who do not comply with these guidelines.

- All clothing should be neat in appearance (not faded, no holes, etc.) and not be too tight, loose or revealing.
- With the exception noted in the dress code, no wording or pictures should be on the clothing.
- This dress code applies to time spent at the school, all extra curricular activities and athletic events, both home and away.
- During cold weather proper attire must be worn (boots, hats and gloves). This is necessary for time spent outside. When jackets and coats are necessary, they must be worn properly.

If a student does not comply with this dress code, the student's teacher will discuss this with him/her. If he/she continues not to comply, the student will be sent to the office for a review of the offense. Repeated non-compliance will result in a consultation with the assistant principal and the parent. Further offenses may result in suspension.

## **DRESS CODE**

### **Pants**

- Dress pant/slack (Chino or Docker Style) solid-colored navy blue, black, grey, or tan.
- No cargo pants, no corduroys, and no denim.
- Pants must be worn at the waist, and fit the body properly in proportion to the waist, inseam, and length.
- Shorts and Girls' Capri's have same rules as above and are allowed in September, October, May and June. The length of the shorts must be no shorter than 4" from the floor when kneeling.

### **Shirts**

- Solid-colored polo-style shirts with a full short sleeve (no capped sleeves).
- Solid-colored polo shirts with a long sleeve.
- Logo's small than a 3 x 5 card is acceptable.
- Shirts must fit the body properly in length, neck, arm length, and torso size.
- Only the top button may be unbuttoned.
- All shirts will be tucked in.
- Solid-colored turtlenecks may be worn under a sweater (No mock turtlenecks).

### **Sweaters**

- Solid-colored sweaters (v-neck, crewneck, vest or cardigan).
- Sweaters must fit the body properly in terms of length, arm length, and torso size.
- Shirts must be worn under all sweaters and tucked in (see shirt list from above).

## **GIRLS DRESS CODE**

- All dresses, skirts, skorts, or jumpers must be solid-colored navy blue, black, grey, or tan and are to be no shorter than 4" from the floor when kneeling.
- Jewelry is permitted with the exception of large hoop earrings.
- No makeup, glitter, or body art.



## BOYS DRESS CODE

- No facial hair.
- Haircut to be styled to end at the collar and not to exceed the bottom of the ears. Hair should not extend below the eyebrows.

## HAIR

Hair should be clean, neat, and well-groomed, with no extreme styles.

## SHOES AND SOCKS:

Dress shoe, athletic shoe, or sandal is acceptable; all shoes and sandals must be worn with socks. Sandals must have a back strap. Heels must not be larger than 2". All tennis and athletic type shoes must have a white sole or non-marking sole. Shoes requiring laces must be properly laced and tied.

## OTHER

- Tattoos and body piercing are not permitted.
- Only girls may wear earrings.
- Hats and sunglasses may not be worn in school.
- Outerwear such as jackets, sweatshirts, fleece tops, etc. may not be worn in class.

**Dress Code Clarification:** Dress pant/slack (Chino or Docker style) solid-color navy blue, black or tan. No cargo pants (pants with exterior pockets on the leg, etc.) NO corduroy and NO denim (no denim material, no rivets at the pockets, any embellishments or decorative stitching).

**Dress Code Clarification:** you may wear a short or long sleeve polo shirt. Regarding short sleeve polo shirts, you may NOT wear a shirt or undershirt which extends below the sleeve.

**Dress Code Clarification:** a short sleeve polo shirt must have measure 1 ½ "or longer, under the armpit. Any sleeve measuring under this will be considered a "cap" sleeve.

## Dress for Cold Weather

We will not take the children outside if the temperature is below 10° F (The Wind Chill Factor is considered). When the temperature is 10° F or above, we **do** go outside for recess. **This means that students should be properly dressed – snow pants, boots, hat, & gloves. This means that all children do go outside.** A teacher can't take some out and leave some behind unsupervised. *If a child is too sick to go outside, then he/she should not be sent to school for that day.* Of course, we will still honor notes from a doctor stating that the child should be kept inside during a period of recovery from an illness or injury.



# FLOOR PLAN

St. Peter Lutheran School

*Caring for today . . . Preparing for Tomorrow*

visit [www.sples.com](http://www.sples.com) for more info

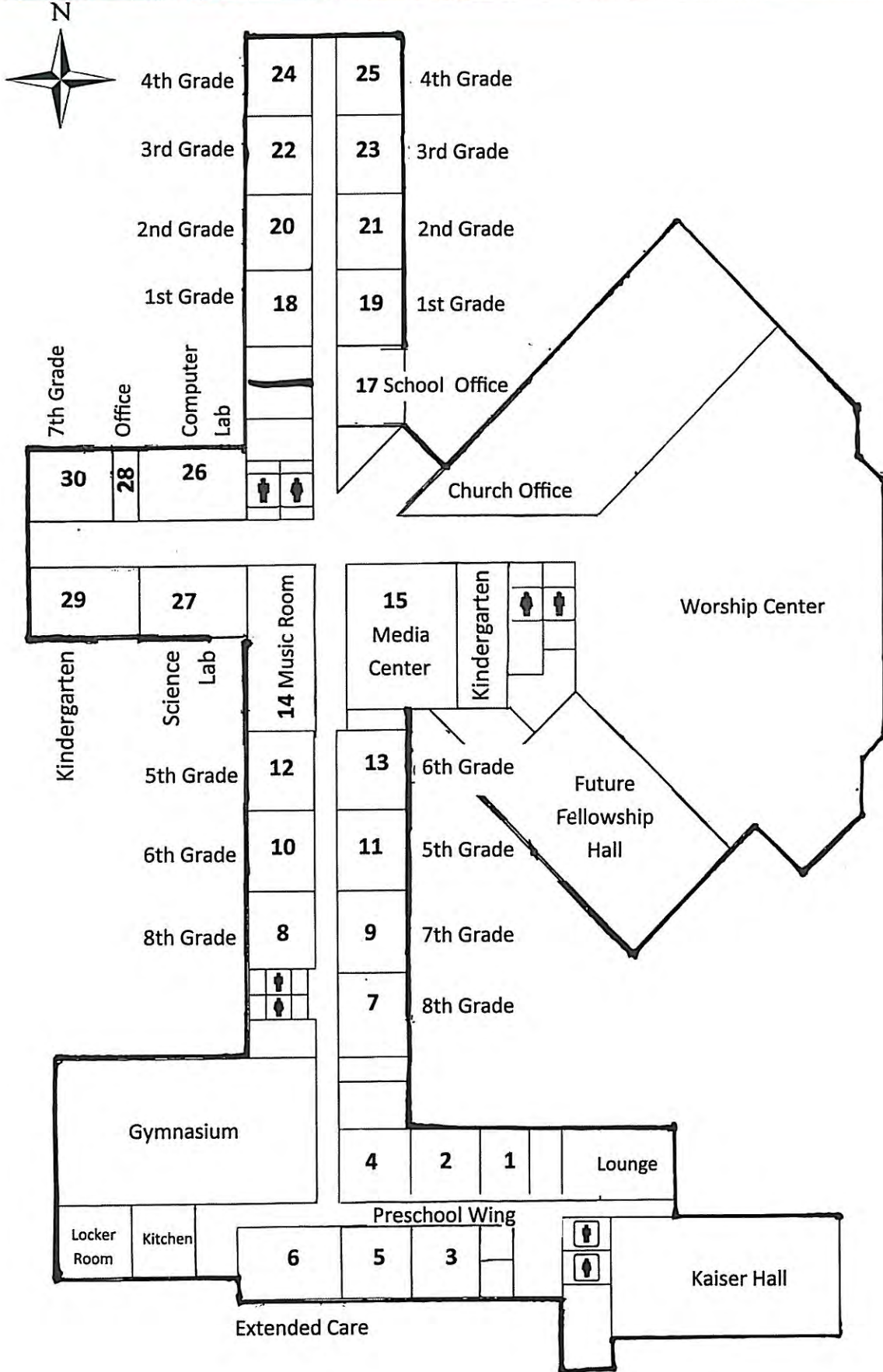

Ronco Plank Road



# WELCOME

St. Peter Lutheran School

*Caring for Today . . . Preparing for Tomorrow*

visit [www.splcs.com](http://www.splcs.com) for more info

Dear Friends in Christ,

Thank you for considering St. Peter Lutheran School for your child's education. "Caring for Today... Preparing for Tomorrow" are the words we use to describe our school. We have a caring group of teachers and staff, who work each day to provide an outstanding education in a safe, Christian environment, preparing our students academically, physically, and spiritually for their life in the world.

Enclosed is some general information about our school programs. Our classrooms serve students from 3-year-old preschool through 8<sup>th</sup> grade. Our educational offerings are challenging and diverse. We also have a wide range of athletic and extra-curricular activities.

If you have questions or would like to schedule a personal meeting and/or tour, please contact us through the school office. May God bless and direct you as you make important decisions about your child's future education.

In Christ,



**Kyle B. Chuhran**  
Principal  
[kchuhran@splcs.net](mailto:kchuhran@splcs.net)

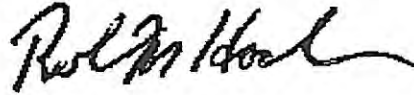

**Robert Hoch**  
Assistant Principal/Athletic Director  
[rhoch@splcs.net](mailto:rhoch@splcs.net)



Welcome and thank you for considering St. Peter Lutheran School for your child's education. My name is Renee Finkel and I am the Admissions Counselor here at St. Peter. It is my responsibility to assist you any way I can through the admissions process here at our school. Please call me at any time or email me at [rfinkel@splcs.net](mailto:rfinkel@splcs.net) with any questions that you may have. If you would like we can set up a tour of our facility and we can discuss any specific questions you may have about your child's future education.

We have included an application form. When submitting the application please be aware there is a \$120 non-refundable application fee. If transferring from another school please submit your child's previous report cards along with the application.

Once accepted, if you are a kindergarten family, we will provide you with the date of our Kindergarten Round-Up where you will have an opportunity to meet with our Kindergarten Staff. Families with children in grades 1-8 will be required to attend Final Registration which will be held in Mid-August. Also an orientation will be held for new families with children in grades 1-8. Please feel free to contact me at any time at 586/781-9296. I look forward to guiding you through our admissions process and welcoming you to be a part of our St. Peter Lutheran School family.

God's Blessings,

**Renee Finkel**  
Admissions Counselor  
[rfinkel@splcs.net](mailto:rfinkel@splcs.net)





**Bob Hoch, Athletic Director**

## **PHILOSOPHY**

It is the aim of the St. Peter athletic program to instill in the hearts of the children a greater love and child-like faith in their Lord Jesus Christ and to show that love to others. Through participation in sports, it is hoped that the student-athlete will further develop spiritually, mentally, emotionally, physically, and socially. Students will be encouraged to be the best they can be by doing the best they can do to the glory of God. We teach loyalty to Christ, school, and team over self.

## **NSLAA**

Our teams play in the North Suburban Lutheran Athletic Association. There are twelve schools in the association divided up into two divisions. The schools are located in Macomb and Oakland counties.

## **TOURNAMENTS**

Our teams are invited to play in a variety of tournaments throughout the metro Detroit area and out of town.

## **OFFERINGS**

FALL: CROSS COUNTRY (5th - 8th Grades) VOLLEYBALL (5th - 8th Girls) SOCCER (5th - 8th Grades)  
WINTER: BASKETBALL (5th - 8th Grades) CHEER TEAM (5th - 8th Girls)  
SPRING: TRACK (5th - 8th Grades) SOFTBALL (7th - 8th Girls)

## **HOOP IT UP (INTRAMURAL BASKETBALL PROGRAM)**

We offer a Basketball Intramural Program to students in 1st through 6th grade. Fundamentals are stressed and teams are evenly divided for safe and fair competition.

## **VOLLEYBALL TOURNAMENT**

We offer an eight- team volleyball tournament to girls teams' in the Metro-Detroit Area.

## **SOCCER TOURNAMENT**

We offer a six - team soccer tournament to 5/6th grade soccer teams in the Metro-Detroit Area.

## **MEL OTT BASEBALL**

We offer the opportunity for students in kindergarten through eighth grade to join one of our many teams: T-Ball, Coach Pitch, Kid Pitch, Beginners, and Juniors.

## **BOOSTER CLUB**

The St. Peter Patriot Boosters Club was established to support the athletic program in the effort to facilitate sports activities.

- ◆ To provide funding for tournaments, referees, equipment, uniforms, and supplies.
- ◆ To develop programs which aid in the development of the athletes.
- ◆ To provide workers for the score tables at our games.
- ◆ To support the athletic director in accomplishing the overall athletic programming.

The Boosters provide concessions, camps, tournaments, clinics, All Star Games, Pep Rallies, and a Patriot Walk in September, for promoting health, and recognizing the heroes from the tragedy on 9/11.



## *Caring for Today . . . Preparing for Tomorrow*

We would like to share a few testimonials from the friends, parents and students of St. Peter Lutheran School, Macomb. We are very proud of our school and it is fulfilling to see examples of others who appreciate the Christian education you receive at St. Peter.

"Enrolling in a new school can prove to be an anxious experience not only for the student, but also for the parent. As parents, we tend to experience our children's anxiety right along with them, however God is good!! God's Word tells us in *Philippians 4:6-7 Do not be anxious about anything, but in everything, by prayer and petition, with thanksgiving, present your requests to God. And the peace of God, which transcends all understanding, will guard your hearts and your minds in Christ Jesus.* I thank God for being true to His Word, and I thank the staff and families of St. Peter Lutheran School for making my son and I feel so welcome and included in ALL school activities during his first year at St. Peter in the 4th grade, and for the continued friendships that have developed and continued into our second year at the school. I am happy to say that St. Peter Lutheran School welcomed my family warmly, and immediately felt like "home", and still does today." *Maria Randazzo, parent of current student at St. Peter*

"You should go to St. Peter because you can learn about Jesus. We sing songs about Jesus. We sing God Bless America. The teachers are nice. Sometimes they will give you hugs. The teachers give you homework. My teachers love me even if I'm Loud." *Jack May, St. Peter Kindergarten student*

"The strengths of this school are the Christian Lutheran teachings, other parents who care, teachers who devote their life to the children and their Lord. I am so proud that our children attend St. Peter. I thank God for our church and school, the teachers, staff and parents every day. I think the Mentor Parent program that Mr. Chuhran implemented is an EXCELLENT program. We take so many things for granted as parents of the school who have "already been there, done that" that we don't even realize how confusing some of the policies, projects or way of doing things are to somebody new to the school or particular grade for that matter." *Parent of current St. Peter students*

"I love St. Peter because I can learn about Jesus and I know it is getting close to his birth. The teachers are really nice. Mr. Chuhran and Mr. Hoch are nice too. The other kids are nice too. I love it because the school teaches me to show Christian love. My teacher says we should have a kind heart." *Gabrielle Hatfield, 1st Grade student at St. Peter*

"St. Peter teachers really care about their students and their student's families! Our family has gone through a very difficult time the past few months with the loss of a father/grandfather and sister/aunt. These family members lived out of state which made everything more difficult because we couldn't always be there in person to support them. Our family received such support from our friends, school faculty and church staff. We could not have gotten through this time without our praying friends at St. Peter. One of our teachers took some extra time to write a note to my mother to let her know that she had been praying for our family. The note touched my mother's heart and comforted her to know that her grandsons were in a Christian school that had such caring teachers! Our family is so thankful for the countless hours our teachers put in to our children's daily life." *Parents of current students at St. Peter*

"When you become a St. Peter Patriot you are becoming a Christian. You could like to help, volunteer, and teach other people about God's word. You also want to give people hope. You may like going to church, Bible Study, chapel, or Sunday School. When you become a St. Peter Patriot you will make other people want to be a St. Peter Patriot too." *Sabrina Gottshalk, St. Peter 4th Grade student*

"As parents of two children, we choose to send our kids to St. Peter Lutheran School, because we know from our experience thus far, that our children are getting the best possible Christian (faith based) education. We feel very strongly that with a parochial school like St. Peter, our kids are being educated along side children of parents & teachers who share in the same common interests for our children. With St. Peter, we know that our kids will never be denied the opportunity to practice their Christian faith while they attend school." *Rob & Francesca Keller, parents of St. Peter students*

"A patriot is a person who vigorously supports their country and is prepared to defend it against enemies or any other types of evil. You can be a patriot by defending your friends, family, or property. I am glad to be an eighth grade patriot because not only can I defend my classmates but I can teach the younger children how to act and behave. I think a major part of being a patriot is incorporating Jesus and His word into your life. Jesus means everything to me and I hope everyone can have Him in their life. Jesus was a huge patriot by defending His beliefs and never caving into sin." *Matteo Munaco, 8th Grade student at St. Peter*



# WE ARE PROUD TO OFFER . . .

St. Peter Lutheran School

visit [www.spiles.com](http://www.spiles.com) for more info

*Caring for Today . . . Preparing for Tomorrow*

## **CHRIST-CENTERED ENVIRONMENT:**

Worship Center

Resource Room

Media Center

Computer Lab

Science Lab

HIS Rock (Youth House)

Small Class Sizes

Safe & Secure Atmosphere

Prominent Facility/Location

30,000 sq. ft. of Air Conditioned Classrooms with recent technology enhancements

## **MUSIC PROGRAM:**

Band - Grades 5-8

Choir - Grades K-8

Handbells - Grades 5-8

## **ATHLETIC PROGRAM:** (See Patriot Sports Section)

**EXTENDED CARE:** Extended Care is for children enrolled in St. Peter Lutheran School. There are nominal fees for this service. Extended Care will provide the students supervised study and play time, following the same schedule as the school regarding vacation time and days off. Hours available are 7:00 am - 8:00 am and 3:00 pm - 5:30 pm.

**STAFFED NURSERY:** A free staffed nursery available is to parents volunteering at school or attending Bible study.

**TRANSPORTATION:** Bus transportation is available to students residing in the Utica School District.

## **EXTRA CURRICULAR ACTIVITIES:**

Science Olympiad

Lego Robotics

American Heritage Girls

Cub Scouts

Math Club

Band/Handbells

Choir

Yearbook Club

**PARENT TEACHER LEAGUE (PTL):** The PTL is the school's Parent Teacher League. Membership is open to all parents, guardians, and teachers of children enrolled in St. Peter Lutheran School. The PTL objectives are as follows: 1) To bring about a close cooperation between the parents and the faculty in the interest of the child and school. 2) To assist the church and the parents in fulfilling their obligation to bring up their children in the nurture and admonition of the Lord. 3) To assist in securing necessary funds for the school.

**MOTHERS OF PRESCHOOLERS (MOPS):** MOPS stands for "Mothers of Preschoolers" – but don't let that confuse you. MOPS is about meeting the needs of every mom of a child from conception through kindergarten with **local groups of moms just like you.** Whether you're urban, suburban, rural, stay-at-home, working, teen, adoptive, special-needs, single or married, MOPS is for you!

**MOMS IN PRAYER (MIP):** Moms in Prayer International (has groups around Michigan and the country dedicated to pray for other schools), formerly Moms In Touch, impacts children and schools worldwide or Christ by gathering mothers to pray. Our vision is that every school in the world would be covered in prayer. MIP is open to any mother of St. Peter students.



# WHAT LUTHERANS BELIEVE AND TEACH

St. Peter Lutheran School

visit [www.sples.com](http://www.sples.com) for more info

## *Caring for Today . . . Preparing for Tomorrow*



- The Bible is God's inspired, infallible Word.
- In the Bible, God is revealed as Trinity: Father, Son and Holy Spirit.
- God created the world and all that exists.
- Man is born with original sin and cannot save himself.
- We need God's law to remind us of our sin and move us to repent.
- Jesus Christ, true God and true man, born of the Virgin Mary, died on the cross for

all sins, and rose bodily on the third day.

- Salvation through the forgiveness of sins comes only through faith in Jesus Christ as personal Lord and Savior.

When a person receives Jesus Christ as Lord and Savior, they will want to live according to the will of Christ by...

- putting Christ first in their life,
- worshiping on a regular basis,
- studying God's Word regularly,
- rejoicing in their baptism and participating in the Lord's Supper frequently,
- giving faithfully to the work of Christ's Church,
- seeking ways to serve Him through ministry to others,
- telling others of His wondrous love.

God's Holy Spirit works on the hearts of His people through Word and Sacrament.

God answers the prayers of believers.

God expects all Christians to be baptized, including infants.

Baptism makes you a member of Christ's body, the Church.

The body and blood of Christ are really present in the Sacrament of the Lord's Supper for the forgiveness of sins. Only those who share that belief should commune with us. God strengthens our faith and love through the Lord's Supper.

It is the duty of Christian parents to provide their children the best possible Christian education. St. Peter assists parents in this responsibility with:

- a Christian Preschool for three and four year old children,
- a Christian Day School for grades K-8,
- a Sunday School program for all ages, and
- instruction for 7th and 8th graders leading to Confirmation and reception of the Lord's Supper.

Christian education is not just for the young, but for all ages. Our "New Member Retreat" is offered three times a year to study the chief doctrines of the Bible.





# ABOUT US

St. Peter Lutheran School

visit [www.sples.com](http://www.sples.com) for more info

*Caring for Today . . . Preparing for Tomorrow*

St. Peter Lutheran School is a Preschool through 8<sup>th</sup> grade school of the Lutheran Church-Missouri Synod. We are located in the heart of Macomb, Michigan on the corner of 24 Mile Rd & Romeo Plank.

**MISSION STATEMENT:** The mission of St. Peter Lutheran School is to academically and spiritually prepare young people as Christian leaders who will go into the community, and through their everyday behavior, model the morals, values, and character of a life centered in Jesus Christ.

**ACCREDITATIONS:** National Lutheran School Association (NLSA) and the Michigan Association of Non-Public Schools (MANS).

**ACADEMICS:** Academics are a high priority at St. Peter Lutheran School. Our rigorous curriculum is based on educational standards of the state of Michigan. Students are challenged to meet high expectations of performance and to develop a work ethic that will help them to be successful in their future education and vocation. Our academic program is comprehensive and seeks to integrate technology and innovation, while also applying traditional approaches where appropriate. Our graduates leave St. Peter ready to take on the challenges of high school, whether at a sister Lutheran high school (Lutheran High North or Lutheran High Northwest) or at other area public, parochial, or private high schools. We have a reputation for providing academic leaders for these high schools. See our website <http://www.sples.com/school/academics/curriculum-by-grade/> for a detailed list of our curriculum.

**SCHOOL & CLASS SIZE:** St. Peter Lutheran School for the 2012/13 school year has approximately 380 students enrolled. On average we have about 20 students per class with 2 classes per grade.

**STAFF:** We have dedicated and qualified Christian teachers and staff who are state-certified with a wealth of experience, many holding advanced degrees. The teaching staff engages in professional development to remain current with educational practices and resources. We also have additional staff which includes a Librarian, Technology Instructor and P.E. Instructor (all full-time).

**SPIRITUAL:** Wednesday morning chapel services are held in our Worship Center for our student population. Parents are encouraged to attend these services. Our faith-driven staff provides religious instruction and integration of Christian principles on a daily basis.

**GOAL:** To assist parents in the task of raising their children according to Scriptural guidelines and to approach all areas of the curriculum from a Christian viewpoint.

